



Panasonic HOME IoT Smartphone App Guide

Warning

- A Home IoT Gateway (MKG100C913) (referred to below as the "Gateway") is required to use the Panasonic HOME IoT App. Ensure that your smartphone is connected to the same home wireless network (WLAN) as the Gateway.
- The App uses your Panasonic ID, which you can receive by email from sender.pcpf.panasonic.com.
- You may register only one Panasonic ID. However, there is no limit to the number of smartphones you can register to each Panasonic ID.
- All images shown in this document are for illustrative purpose only.

Contact:

+49-89-45354-2745

Mon.-Thu./8:00~12:00 13:00~17:00
Fri./8:00~12:00 13:00~14:00

Panasonic Life Solutions Europe
Panasonic Electric Works Europe AG

Contents

Before starting, check that the Gateway (MKG100C913) has a permanent connection to the internet.

STEP 1 Panasonic HOME IoT App Initial SetupP.3 -P.7

STEP 2 Checking your Electricity UsageP.8 -P.14

STEP 3 Checking your Air Quality optionP.15 -P.17

Other

SettingsP.19 -P.25

Device Installation P.26

WLAN SettingsP.27 -P.31

Error Messages P.32

Reference Materials P.32

System Overview P.33

STEP1

Panasonic HOME IoT App Initial Setup

Please download the Panasonic HOME IoT App.

* Screen layout may differ depending on your smartphone model.

Screen layout may change without notice. (July 2020)

Note

* Panasonic HOME IoT is a free download.

* iPhone users require an Apple ID to download the App.

* Compatible OS versions:

iOS: Version 11 or higher

Android: Version 5.0 or higher



Android users click here



iPhone users click here



STEP1 Panasonic HOME IoT App Initial Setup

* Registration of the Gateway and sensors must be completed prior to initial registration.
If the Gateway and sensors have not yet been registered, follow the installation process on P.26.

1 Tap to open on the downloaded Panasonic HOME IoT App on your smartphone.

The start screen is displayed.
Tap the "Start" button.

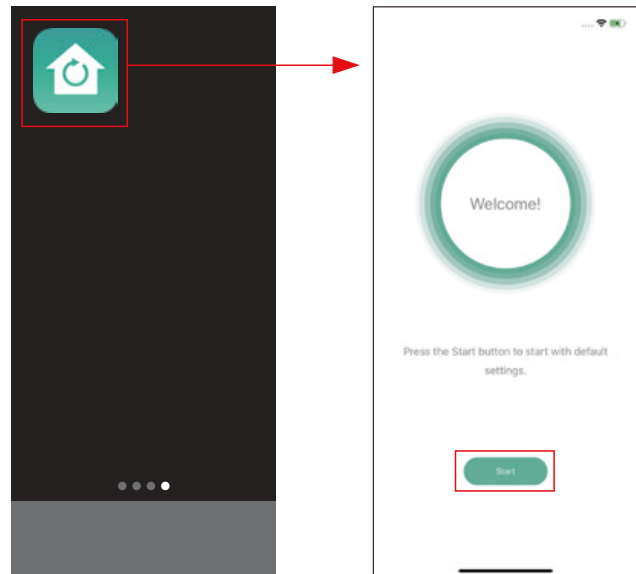

2 Login with your Panasonic ID.

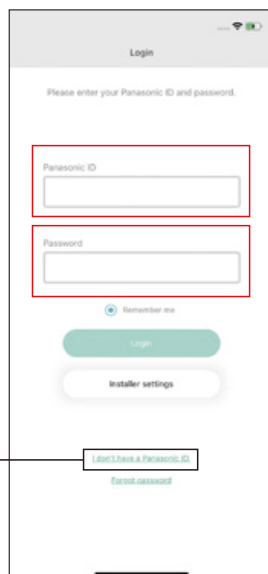

* If you don't have a Panasonic ID, tap the "I don't have a Panasonic ID" link to create one.

3 Check and agree to the Terms of Use and Privacy Notice.

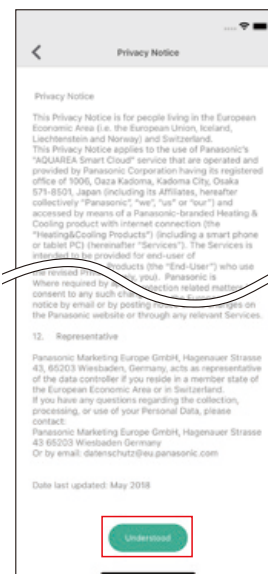

* If you don't agree to the terms you will be unable to use the service.

4 Registering the Gateway with the Server.

Follow the on-screen instructions to complete server registration.

Note

Make sure that your smartphone is connected to the same home wireless network (WLAN) as the gateway.

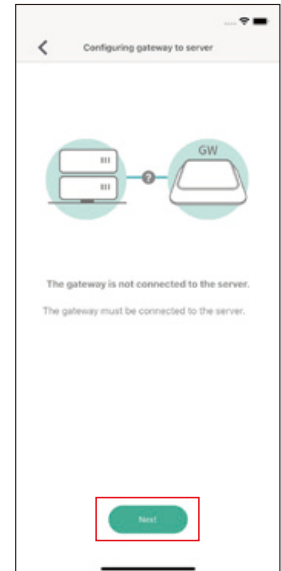

Tap the "Next" button.

The LED will light in orange for 5 seconds to indicate success.

Application LED

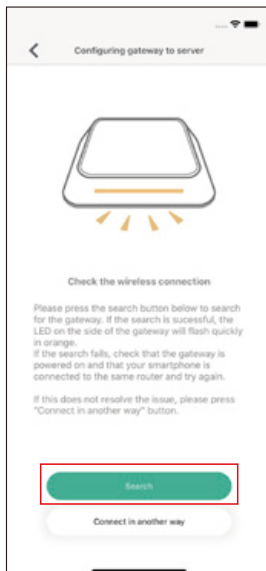

Tap the "Search" button.



Check that the Gateway's Application LED flashes in orange, and tap the Scene Control Button on top of the Gateway. The LED will light in orange for 5 seconds to indicate success.

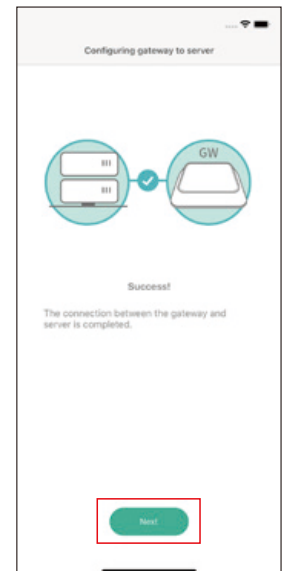

Once registration is complete, tap the "Next" button.

5 Confirm the list of devices registered with the Gateway.

If a Temperature / Humidity Sensor is listed in the registered devices, select its installed location.

After selecting the location, tap the "OK" button on the list screen to move on.

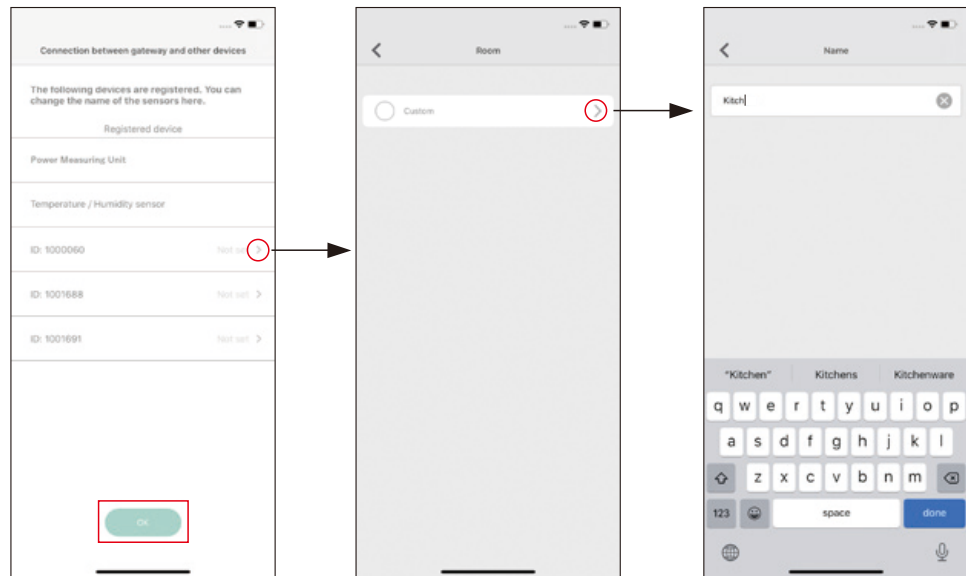

6 Enter your country, postcode and the age of your home.

- * Home country data is drawn from your Panasonic ID registration data.
- * If you change the country, it will also be changed on your Panasonic ID registration.

Select from 3 building age options.

- * If the Temperature / Humidity Sensor (MKG1301913, MKG1302913) is installed, this will be used to analyse ventilation timings.

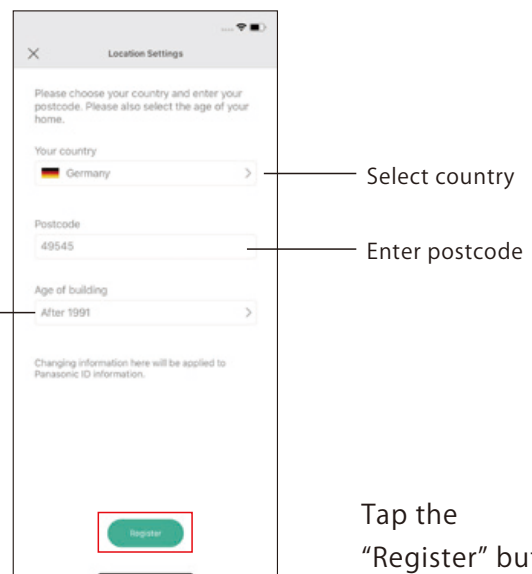

7 Enter details on your electricity usage.

* Information on electricity costs can be found on the bill from your energy provider.

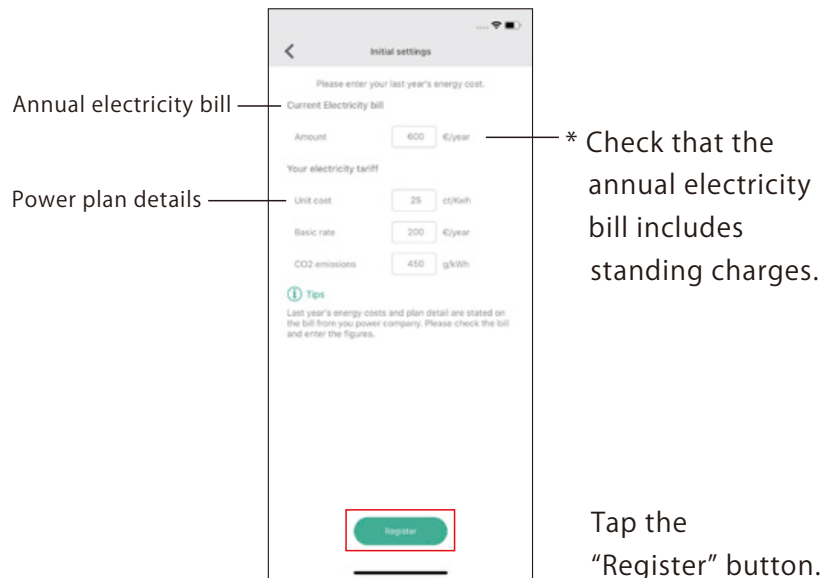

Tap the "Register" button.

8 Initial Setup Complete.

Initial setup is now complete.

If a Power Measuring Unit (MKG1500-DE) is registered, the energy screen will be displayed. If not registered, the air quality screen will be displayed.



Energy screen



Air quality screen

STEP2

Checking your Electricity Usage

* To check your electricity usage you must register the Power Measuring Unit (MKG1500-DE) to the Gateway.



internet



Home IoT Gateway
(MKG100C913)

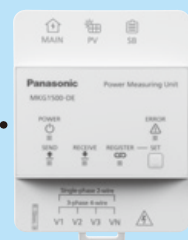

Power Measuring Unit
(MKG1500-DE)

1 Checking this month's electricity usage.

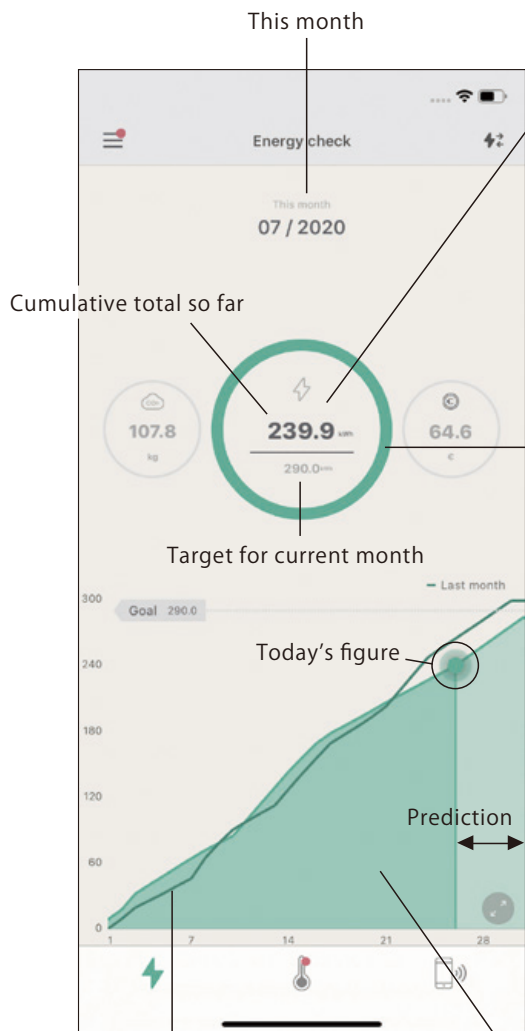

Displays usage, cost and CO₂ emissions.

Tapping on the 3 circles switches between electricity usage, cost and CO₂ emissions.

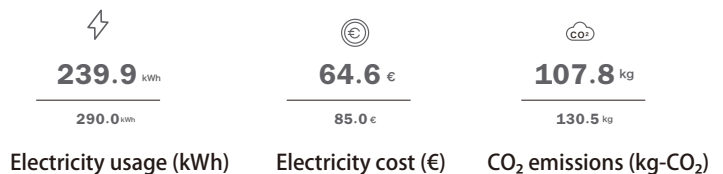

Consumption is colour coded for ease of use.

The current month's electricity usage is displayed as 3 colours.

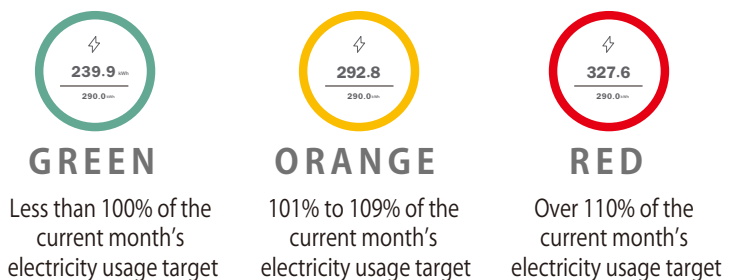

* Targets are calculated from your annual electricity bill in Energy Settings (P.19) (annual electricity bill divided by 12). To change the target, change the value of the annual electricity bill in Energy Settings.

Figure for previous month

If data from the previous month is available, this is also shown on the graph.

Current month's electricity usage data and prediction graph.

Displays the cumulative total for electricity usage in the current month. The period from the following day to the end of the month is shown as a prediction. The prediction helps you to check whether you will meet your target.

* Prediction values are displayed once 6 days or more power data is stored.

Note

Electricity costs are displayed including the monthly standing charge.

2 Electricity usage for the current month can be checked using the Gateway's Application LED.



The Application LED can be configured to be on or off, to display electricity usage or air quality information, and to light or turn off with specific timings.

* See P.20 for more details of setup.



GREEN

Less than 100% of the current month's electricity usage target



ORANGE

101% to 109% of the current month's electricity usage target



RED

Over 110% of the current month's electricity usage target

3 Checking the instantaneous power currently being used.

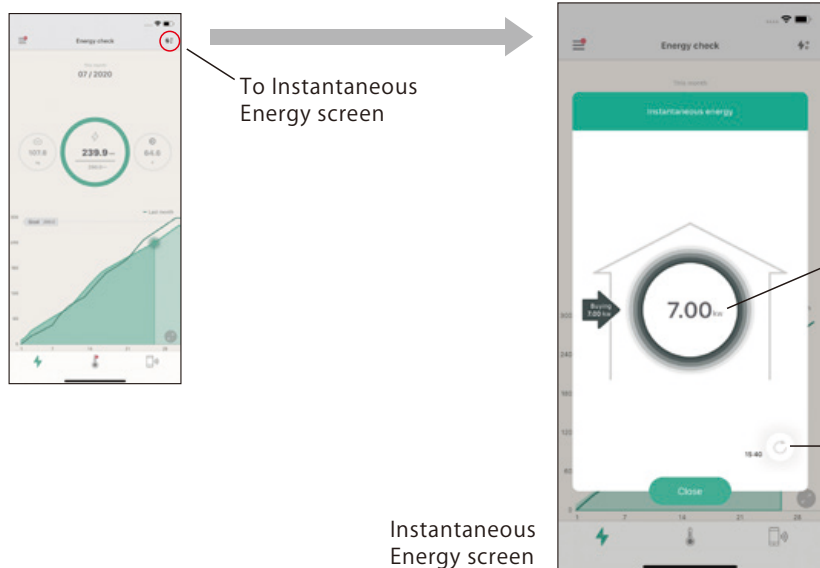

To Instantaneous Energy screen

Instantaneous Energy screen

Instantaneous Energy screen
The screen updates in real time for around 1 minute after opening.

Instantaneous Consumption
Displays the total power currently being used in the home (kW).

Refresh button
This button becomes active after the 1 minute real time refresh has ended. Tapping restarts the refresh process.

Instantaneous Energy screen when a solar generation or storage battery system is installed.

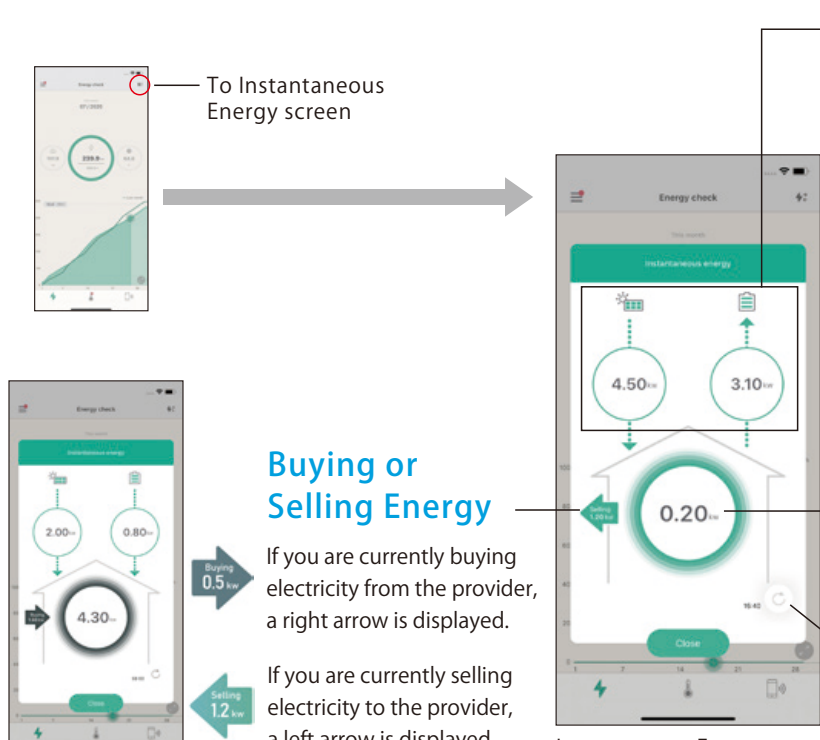

To Instantaneous Energy screen

Buying or Selling Energy
If you are currently buying electricity from the provider, a right arrow is displayed.
If you are currently selling electricity to the provider, a left arrow is displayed.
(* only where solar system is measured)

Power from solar generation and storage battery
Displays power being generated by solar panels.
Displays power passing to or from the storage battery. An up arrow indicates charging and a down arrow discharging.

Total Consumption
Displays the total power currently being used in the home (kW).

Refresh button
Tap the button to refresh the data.

Instantaneous Energy screen

4 Checking detailed electricity usage.

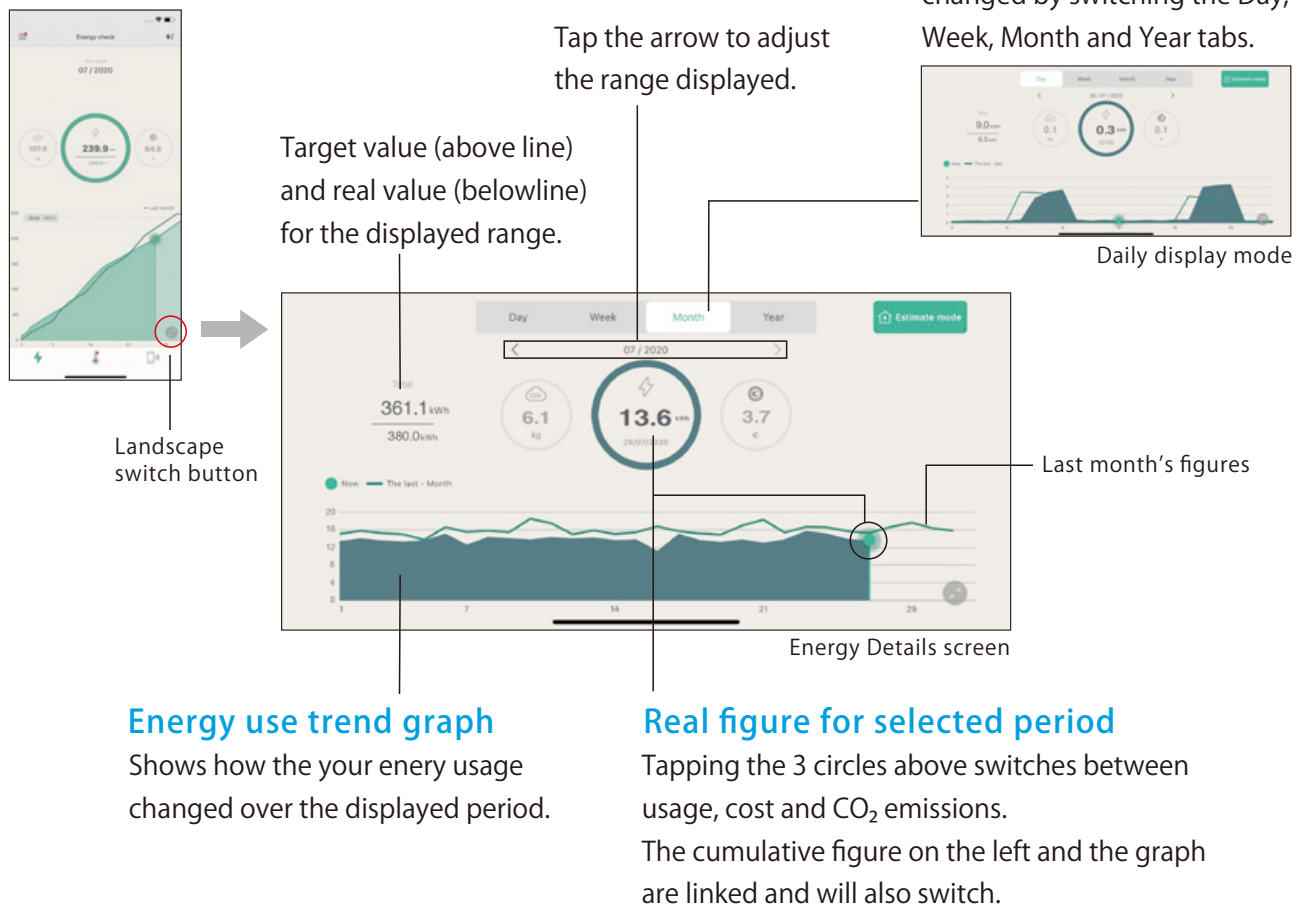

Energy use trend graph

Shows how the your energy usage changed over the displayed period.

Real figure for selected period

Tapping the 3 circles above switches between usage, cost and CO₂ emissions. The cumulative figure on the left and the graph are linked and will also switch.

Display where solar panels or a storage battery is installed.



Breakdown by energy source

A breakdown of energy used by source (PV, SB and grid) is displayed.

* PV is used to mean a solar generating system and SB a storage battery system.

5 Initial setup of Estimate Mode when purchasing solar generation or storage battery system.



Data on energy measurements are used to estimate the effect of installing a solar generation and/or storage battery system. Running estimate mode requires some parameters to be set, which can be done by following the instructions in the App.

Note

If the Power Measuring Unit is already measuring a solar generation and/or storage battery system, Estimate Mode cannot be used.

If Estimate mode has not been configured, tapping this button will open the settings screen.

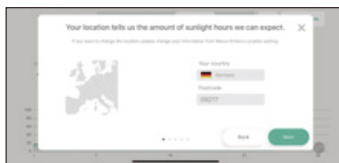

Confirm country / region

The region registered with your Panasonic ID is displayed.
* Changing the region here will also update your Panasonic ID data.



Configure the angle of the roof

Configure the angle of the roof which will have the solar panels.
Use your smartphone's camera function to simply measure the angle.

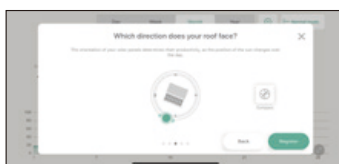

Configure the direction

Configure the direction the solar panels will face. Use your smartphone's compass function to simply measure the direction.

Configure panel direction



Rotate your smartphone to configure the direction of the solar panels.

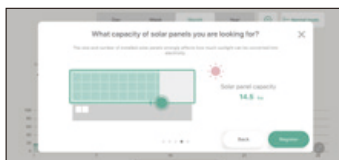

Configure the solar panels

Select the size of solar panel to be installed. Options range from 1.0 to 20.0kW.



Select a storage battery capacity

Select the capacity of storage battery to be installed. Options range from 1.0 to 20.0kW.

Note

Point your smartphone in the same direction that the solar panels will face.

Setup using your smart-phone's camera function Configuring panel position



Try to take the picture of the roof from straight on.

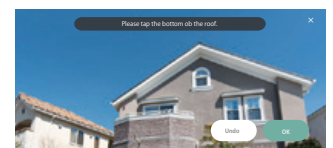

After taking the picture, tap on the ridge, followed by the eaves.

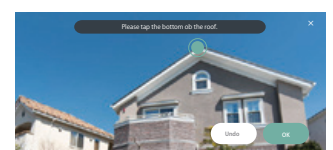

6 Checking Estimate Mode when purchasing a solar generating and/or storage battery system.

Below, PV is used to mean a solar generating system and SB a storage battery system.

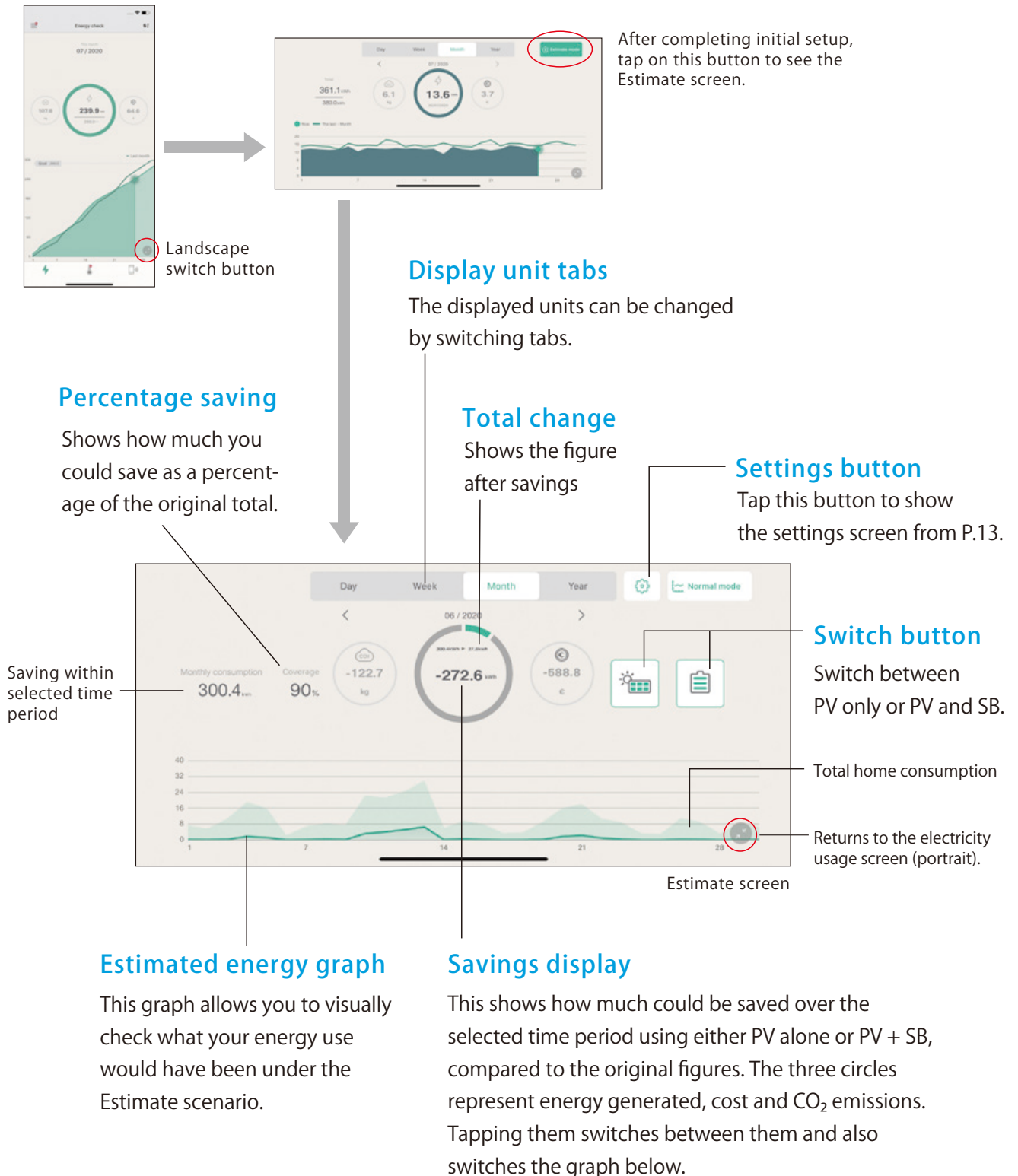

STEP3

Checking your Air Quality option

* The following configuration is required to check IAQ status.

If the following configuration is not setup, only air quality data for your area will be displayed.

**The Temperature / Humidity Sensor is
registered with the Gateway.**



Home IoT Gateway (MKG100C913)



Temperature / Humidity Sensor
(MKG1301913, MKG1302913)

1 Checking current air quality.

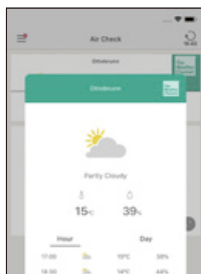

Weather screen

Local weather

Displays a weather report (weather, temperature, humidity).

Tap to open the detailed weather screen.

Check pollen levels

You can also check pollen levels including tree, grass and ragweed pollen. Tap to open the detailed air quality screen.

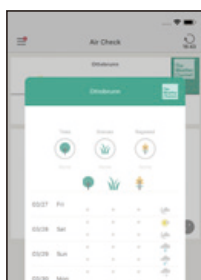

- Very low
- low
- Medium
- High
- Very high

The colour of the dots change depending on the situation (5 stages).

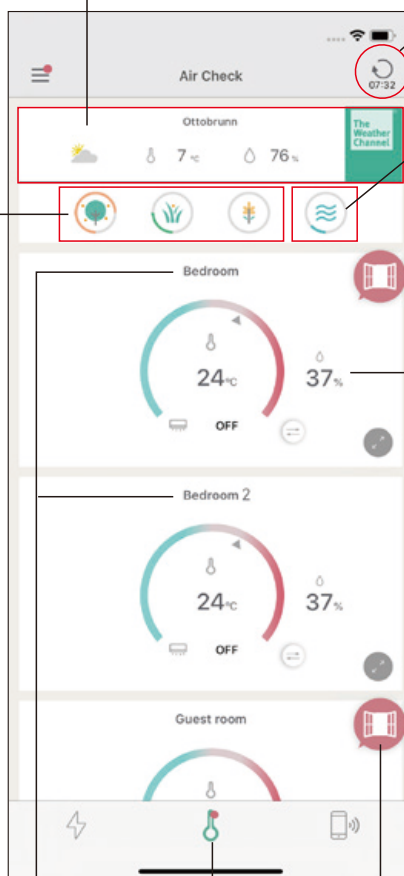

Tap the Reload button to update the data.

Checking air quality levels

The icon indicates air quality.

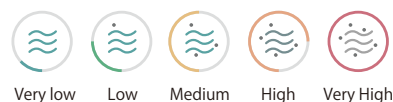

Room temperature and humidity

Displays temperature and humidity information for each room.

* Displayed for rooms with sensor installed.

See P.23 of the Panasonic HOME IoT Installation Guide for installation and setup of Temperature / Humidity Sensor.

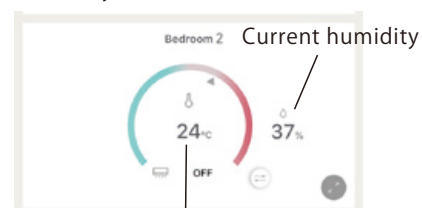

Current temperature

If any room has a ventilation notification, a red dot is shown here.

Room names

Room names can be changed. See P.23.



Ventilation alarm

Notifies you that it's time to ventilate.

If this icon is displayed, ventilation should be used to control temperature and humidity.

Note

* The ventilation alarm may also be displayed where an outside Temperature / Humidity Sensor is installed.

* Indoor Temperature / Humidity Sensors refresh temperature and humidity data every 10 minutes, and outdoor ones every 15 minutes.

2 Checking current air quality details.

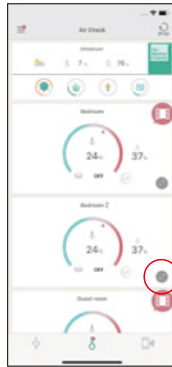

A portrait/landscape button is provided when a Temperature / Humidity Sensor is in use.

Tapping the button opens the more detailed landscape screen mode.

Day:
Displays the temperature and humidity trend for the selected day.

Changes over a day, week, month or year can be viewed.

Tap the arrows to change the displayed range.

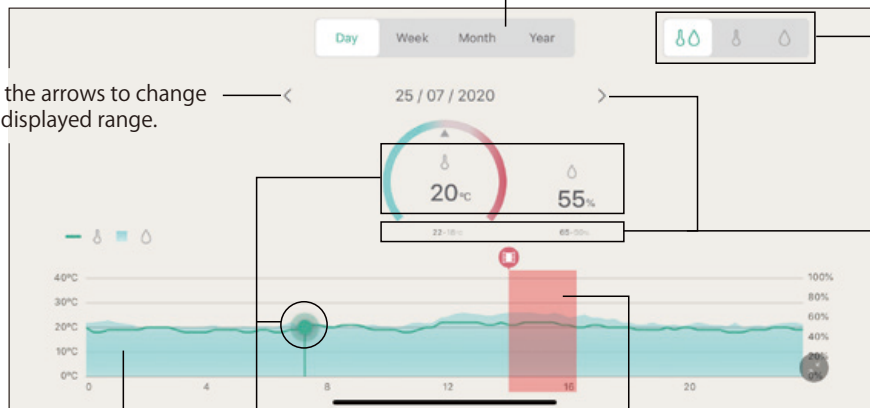

Use this to check the temperature, humidity and how they are changing.

Graph display range

The maximum and minimum temperature and humidity within the selected display range is shown.

View temperature and humidity changes on the graph.

The temperature and humidity for the selected range is displayed.

The red area indicates the period which the ventilation alert was notified.

Week, Month, Year: The trend in the maximum and minimum temperature and humidity over the selected period is shown.

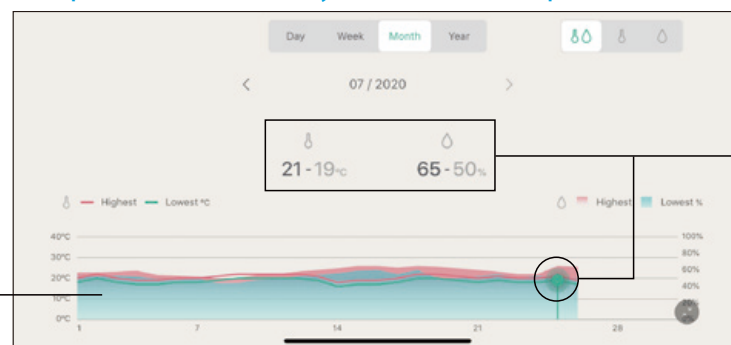

You can check the maximum and minimum temperature and humidity on the graph.

The maximum and minimum temperature and humidity over the selected period is shown.

Monthly change view

Other

Settings P.19-P.25

Device Installation P.26

WLAN Settings P.27-P.31

Error Messages P.32

Reference Materials P.32

1 Settings menu

Allows you to check notifications such as ventilation alarms and error messages.

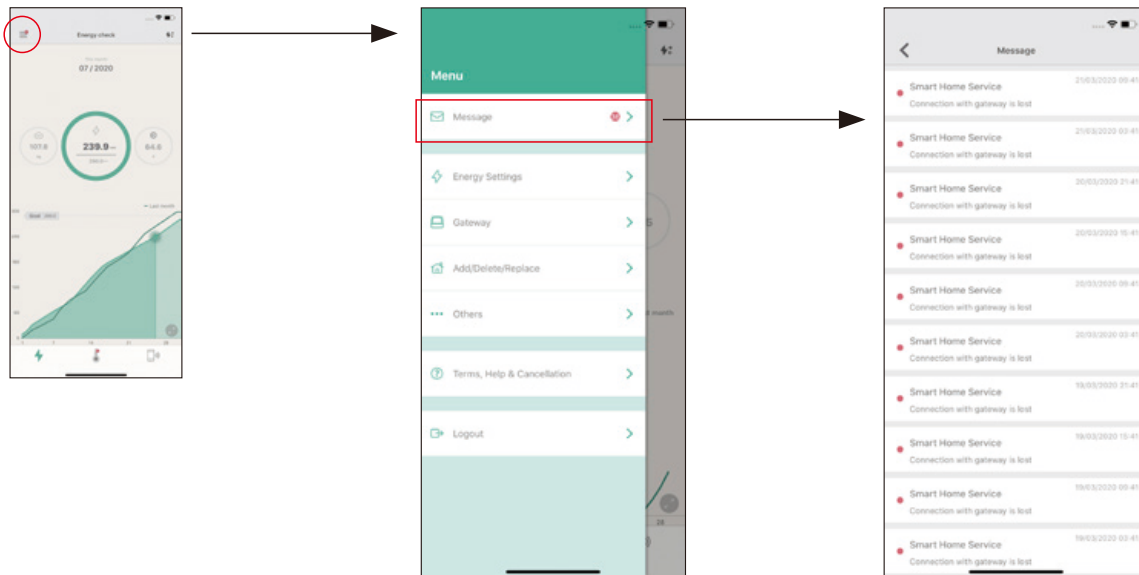

2 Energy settings

Energy settings screen

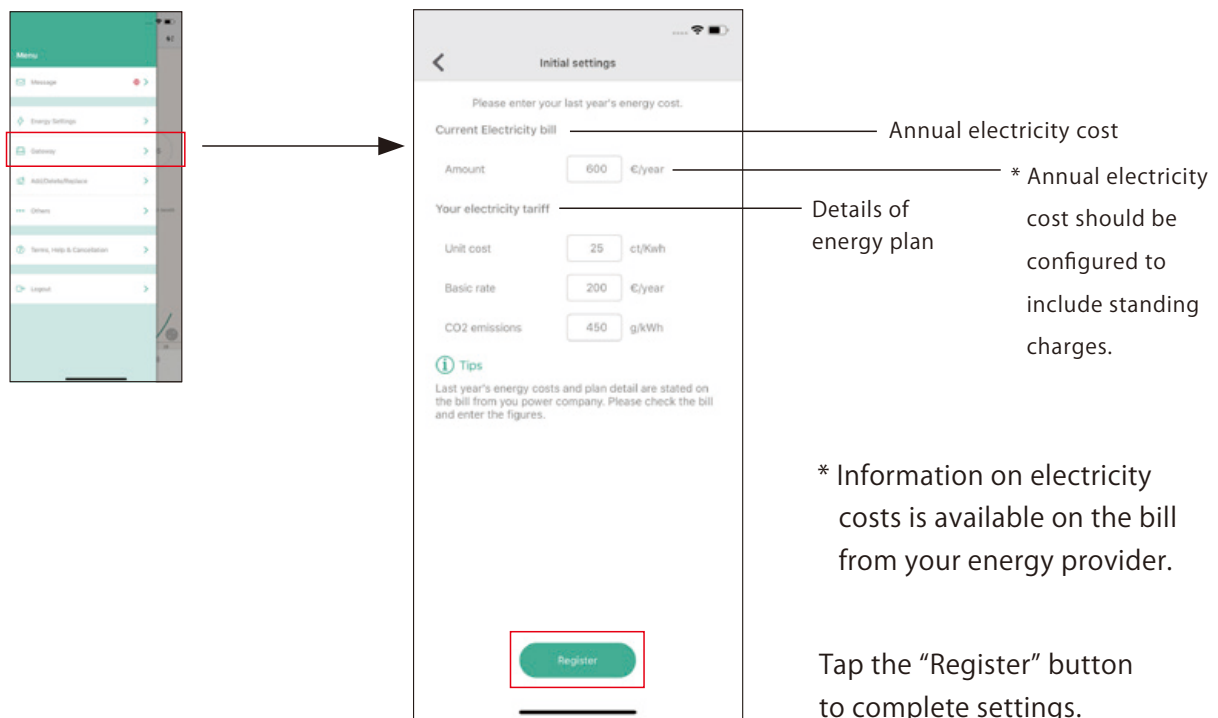

3 Gateway settings

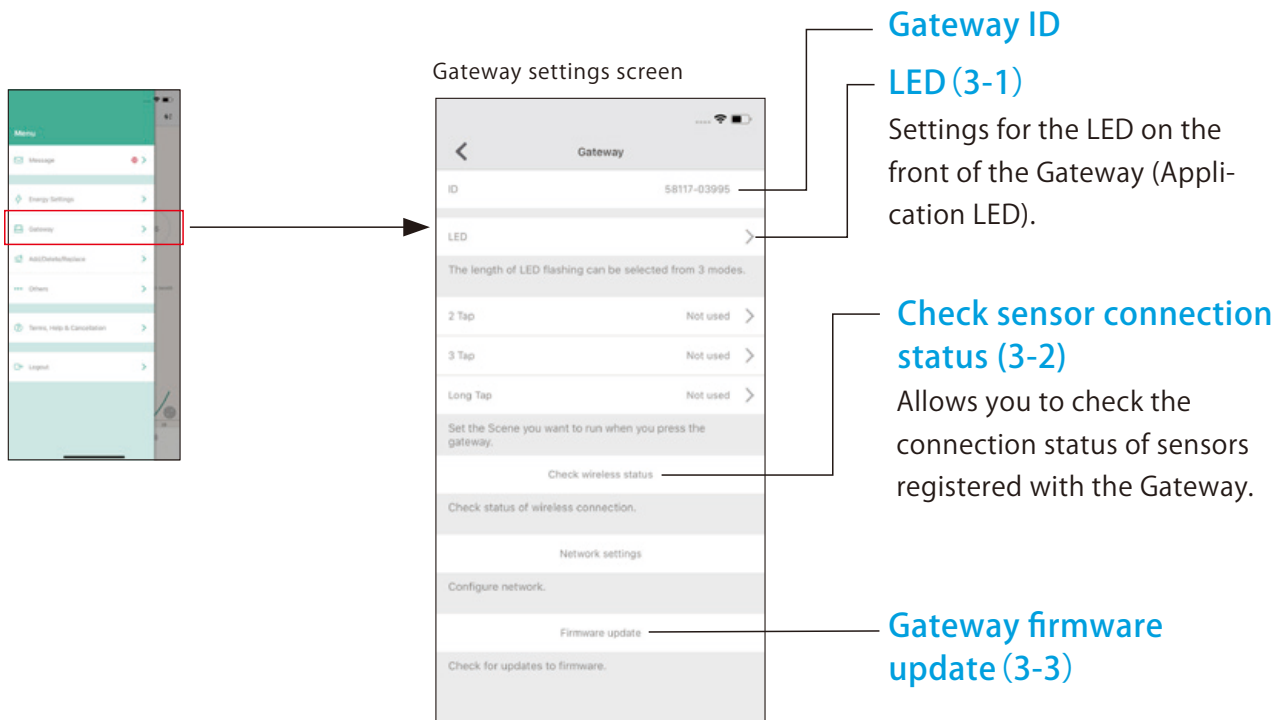

(3-1) Application LED settings

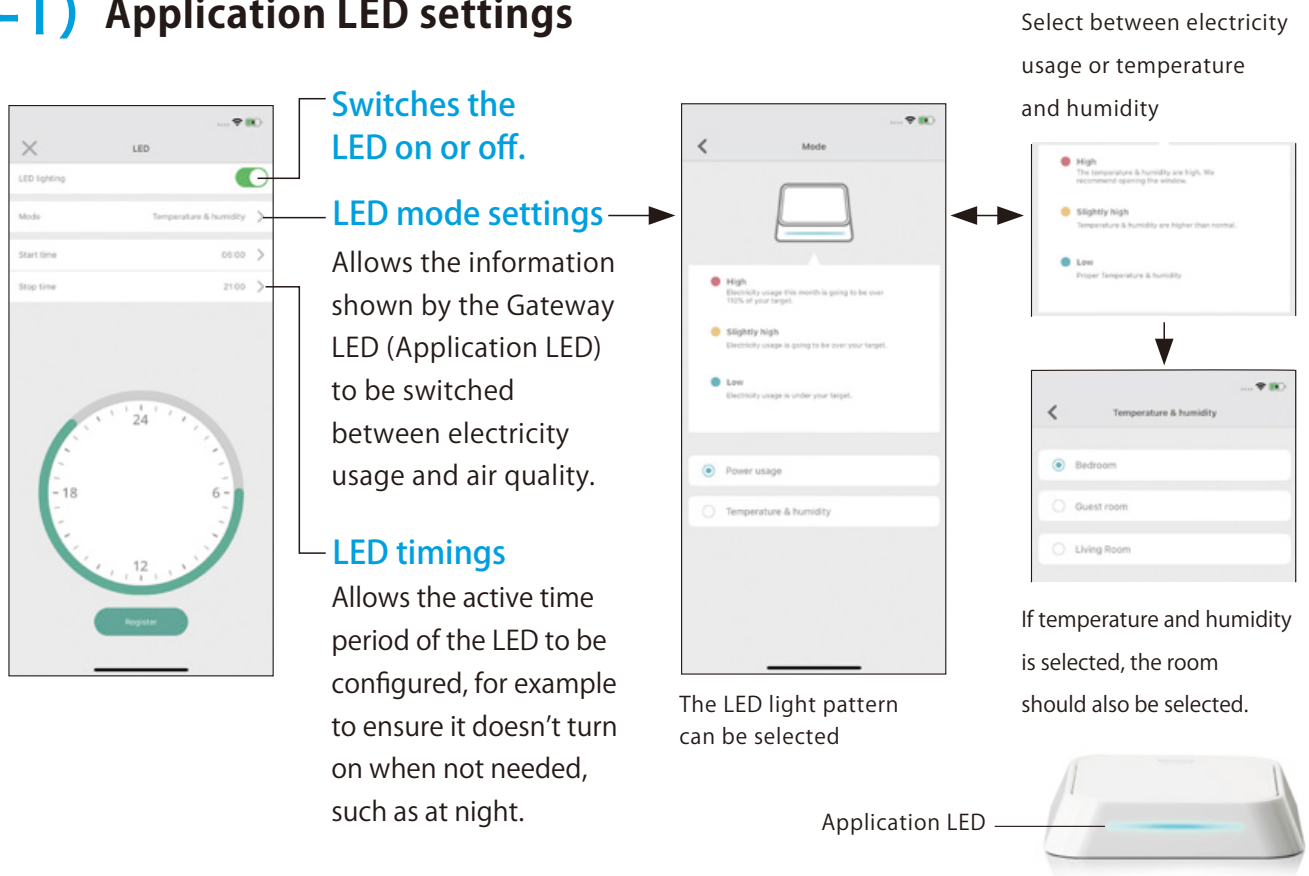

(3-2) Check the signal status of devices connected to the Gateway.

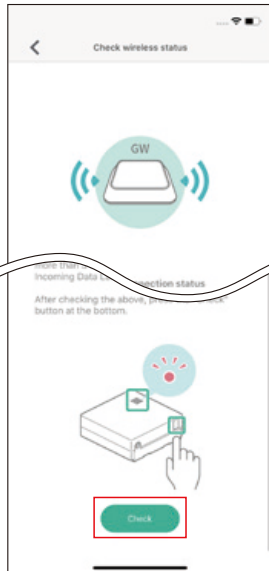

* If a Power Measuring Unit is installed, check that the fusebox cover is closed.

* If a Temperature / Humidity Sensor is installed, hold the Refresh Button on the bottom of the sensor for 3 seconds and check that the Incoming Data Lamp lights in red. After making these checks, tap the "Check" button at the bottom of the screen.

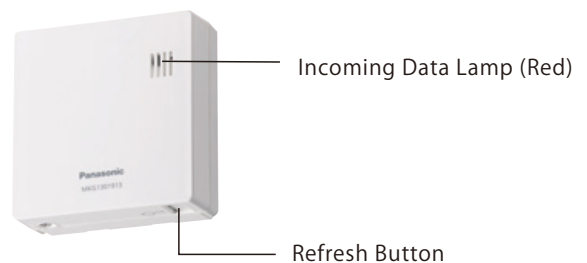

Check the signal status of the Gateway.

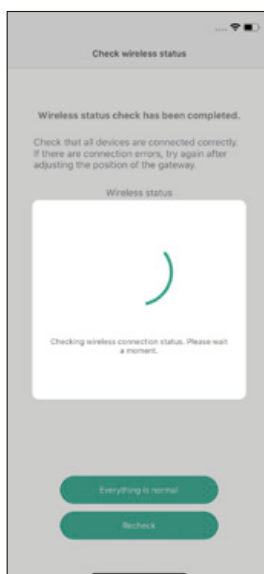

Checking may take several minutes.

Once the checks are complete, tap the "Everything is normal" button.

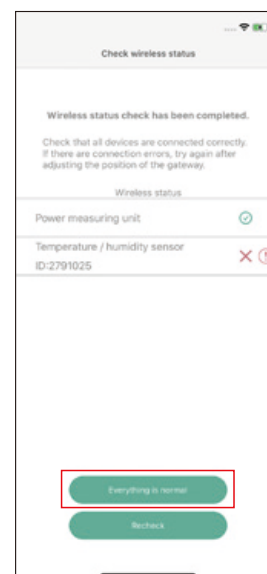

Check the output on the screen to the left. If there are no problems, tap the "Everything is normal" button.

Note

If there is a connection error, adjust the Gateway's position and try again.

(3-3) Gateway firmware update

Checks that your Gateway has the latest firmware.

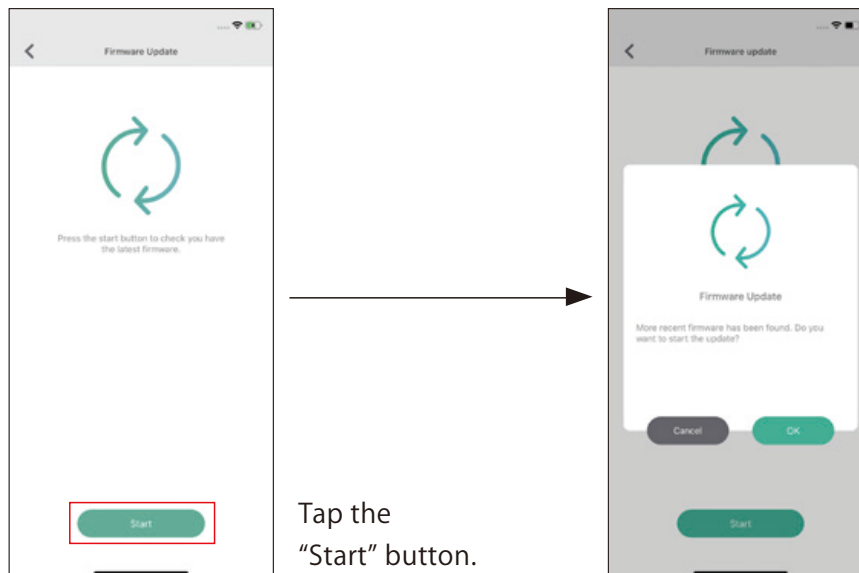
**Note**

Do not power off the Gateway during an update. The update may take around 30 minutes.

4 Adding, replacing and removing devices

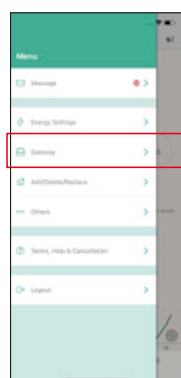

Temperature/Humidity Sensor settings (4-4)

Displays information on registered devices in each room.
Start here to edit a registered device.

Device settings screen

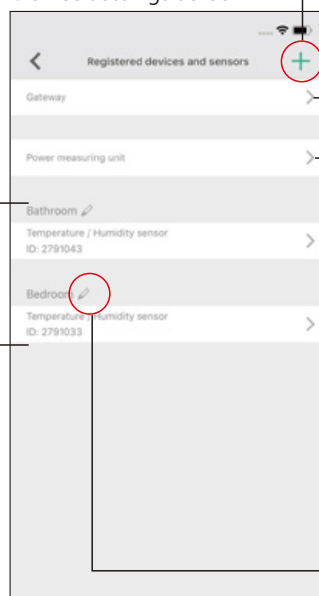

Add a device (4-1)

Start here to newly register a device.

Gateway settings (4-2)

Displays registered Gateway information.

Start here if the Gateway is to be replaced due to a breakdown.

Power Measuring Unit settings (4-3)

Displays information on the registered Power Measuring Unit.
Start here to replace or remove a Power Measuring Unit.

Tap this symbol to change the name of a room.

(4-1) Add a device

Select the type of device to be added and register it. The Panasonic HOME IoT App will guide you through the registration process.

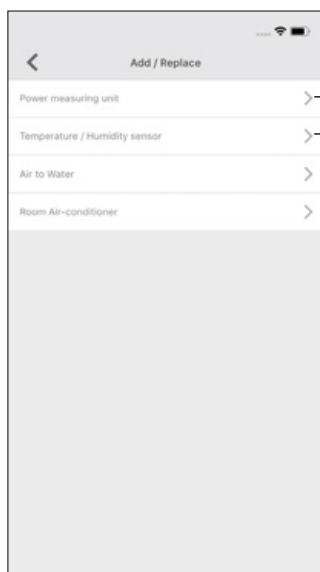

Power Measuring Unit setup
(see P.14 of the Panasonic HOME IoT Installation Guide)

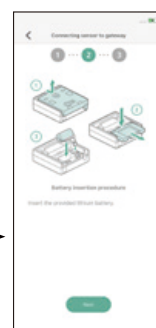

Temperature / Humidity Sensor setup
(see P.23 of the Panasonic HOME IoT Installation Guide)

(4-2) Gateway settings

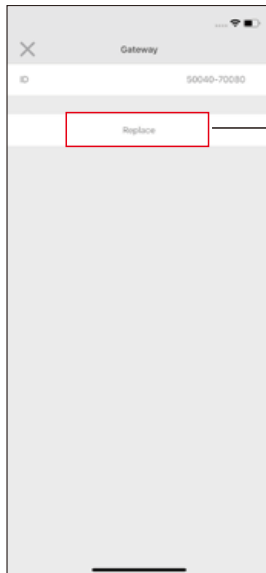

Tap the "Replace" button to start the Gateway replacement process.

(4-3) Power Measuring Unit settings

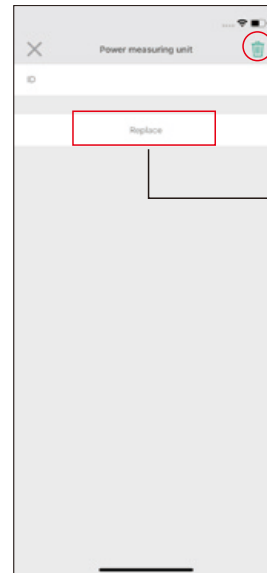

Tap the delete symbol to delete.

Tap the "Replace" button and follow the on-screen instructions.

(4-4) Temperature / Humidity Sensor settings

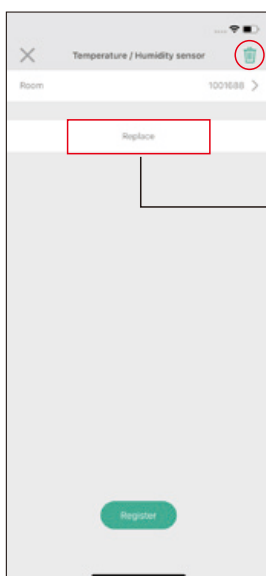

Tap the delete symbol to delete.

Tap the "Replace" button and follow the on-screen instructions to configure.

Deleting a Temperature / Humidity Sensor

Hold the Refresh Button on the Temperature / Humidity Sensor for 2 seconds and check that the Incoming Data Lamp flashes in red. Then, tap the delete symbol to delete the Temperature / Humidity Sensor.

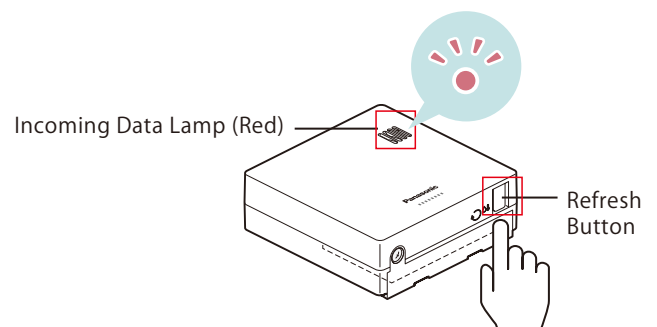

5 Other settings

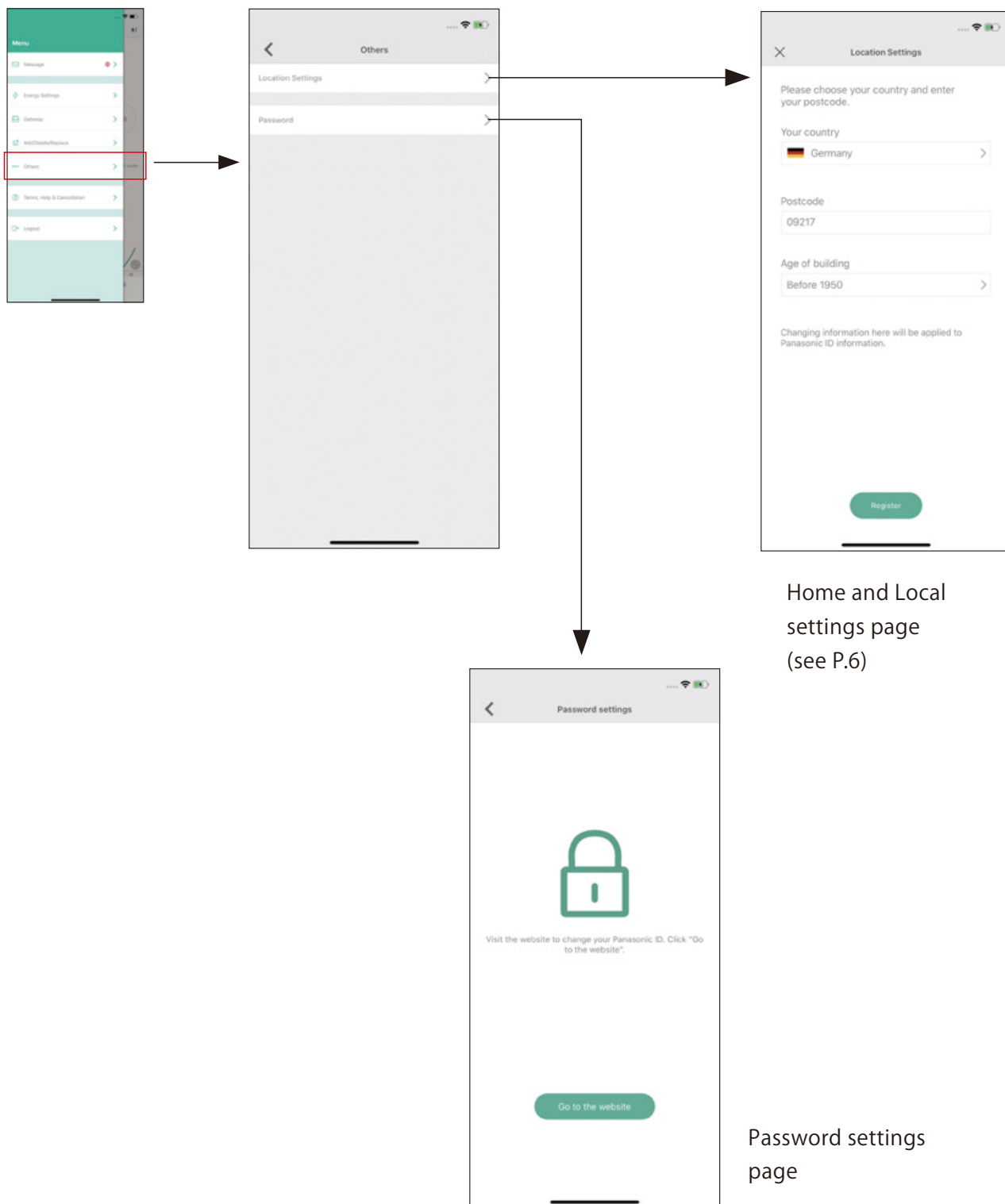

1 Tap the Panasonic HOME IoT App downloaded to your smartphone.

Once the start screen appears, tap the “Start” button.

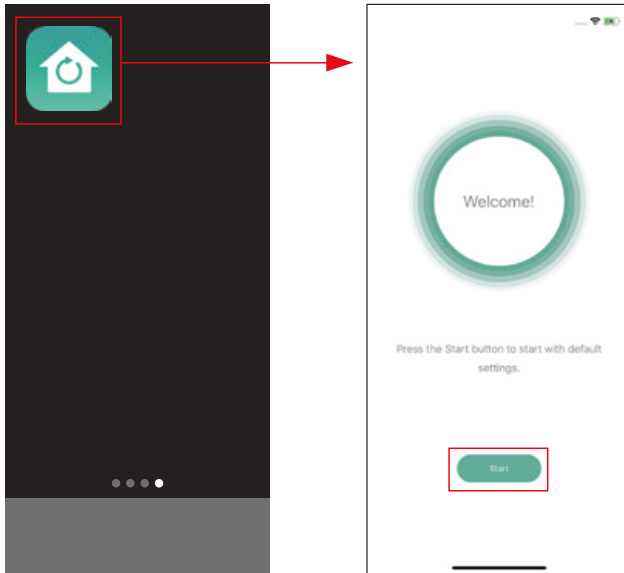

2 Tap the “Installer settings” button.



3 Configure the device by following the process in the Panasonic HOME IoT App.

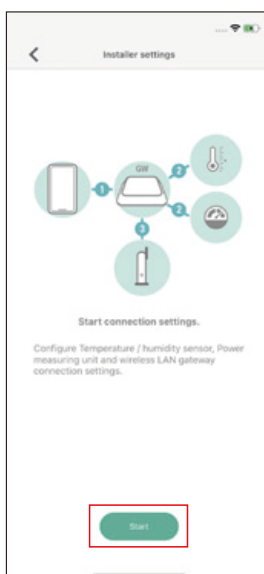

The install process is displayed. Check the details and tap the “Start” button.

* Installation follows the following process.

- 1 Connect your smartphone to the Gateway.
- 2 Register the Power Measuring Unit and sensors to the Gateway.
- 3 Connect the Gateway to the internet.

For more details, see the Panasonic HOME IoT Installation Guide.

1 WLAN Settings

Except during installation, if the user wishes to make changes to the WLAN Router, the network settings page from the menu screen should be used.

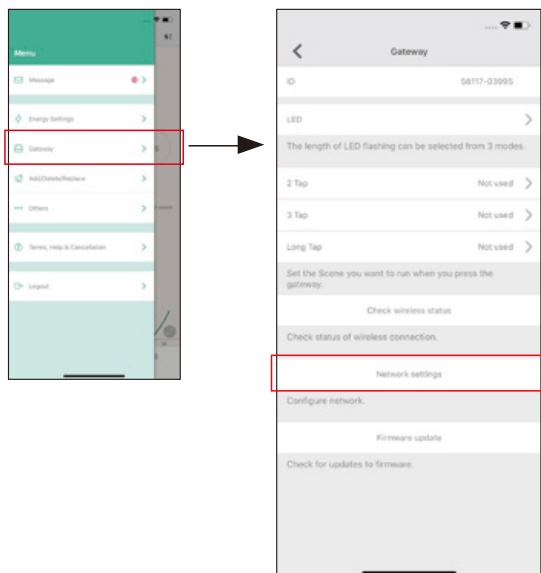

2 Connect the smartphone App to the Gateway.

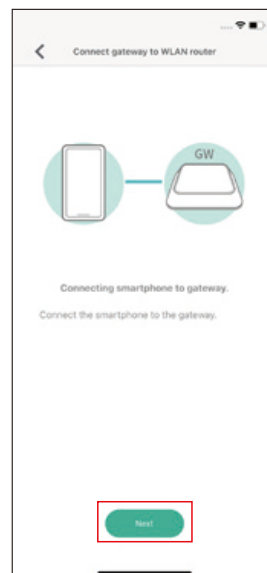

Tap the "Next" button.

3 Switch the connection mode to "On".

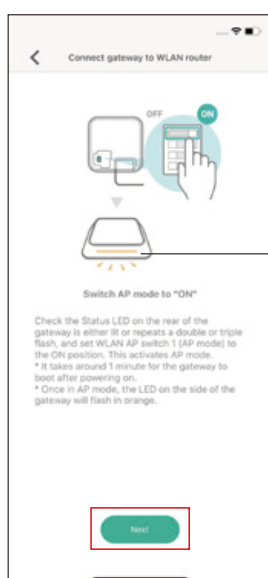

Check that the Status LED on the rear of the Gateway is either lit or double or triple flashing, and set WLAN AP switch 1 to the On position. The Gateway will immediately enter AP mode. Once in AP mode, the Application LED on the front of the Gateway will flash in orange.

Application LED

If there are no problems, tap the "Next" button.

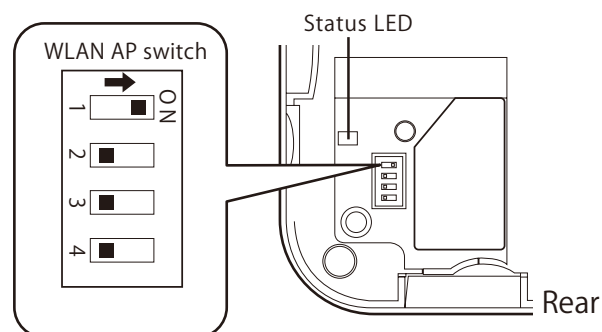

4 Select and connect to the Gateway's SSID using the Wi-Fi Settings on your smartphone.

The configuration process differs for Android and iOS smartphones.

Android



1.

2.

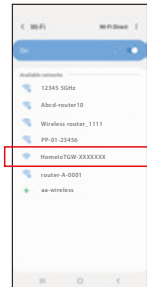

3.

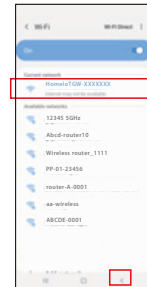

1. Tap the "Go to Wi-Fi Settings" button to open the Wi-Fi Settings on your smartphone.
2. Select the Gateway's SSID.
3. Once the selected SSID has a check next to it indicating it is connected, tap the Back button on your smartphone's navigation bar to return to the Panasonic HOME IoT App.

iOS



5.

1.



2.

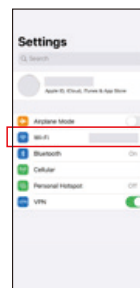

3.

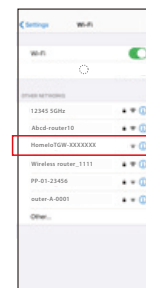

4.

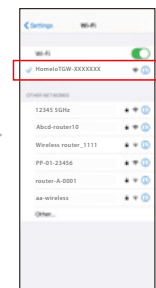

1. Before tapping the "Push here after Wi-Fi Settings" button on the guidance screen, tap your smartphone's Home button to return to your home screen.
2. Tap the Settings icon to open the settings screen.
3. Under Wi-Fi Settings, select the Gateway's SSID.
4. Once the selected SSID has a check next to it indicating it is connected, tap the Home button to return to your Home screen. Now tap the app icon again to return to the Panasonic HOME IoT App.
5. Tap the "Push here after Wi-Fi Settings" button on the guidance screen.

IMPORTANT

The Home IoT Gateway SSID is displayed as "HomeloTGW-XXXXXXX".
* The XXXXXXXX section indicates numbers.

5 The smartphone is successfully connected to the Gateway.

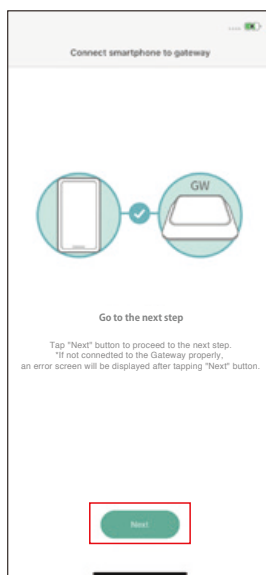

Tap the
"Next" button to
move to the
next step.

6 Connect the Gateway to your WLAN Router.

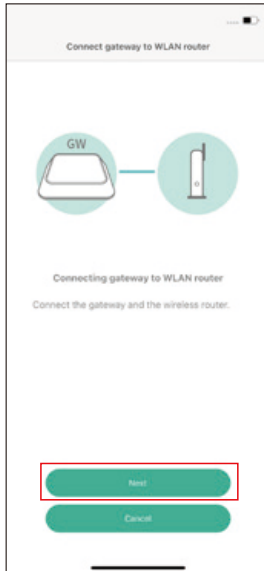

Tap the "Next" button.

7 Check whether your WLAN Router has a WPS button.

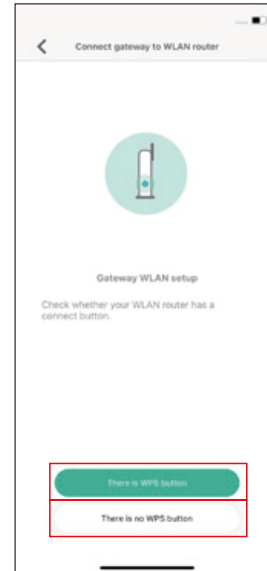

If it does, tap "There is WPS button".

If it does not, tap "There is no WPS button".

If there is a WPS button

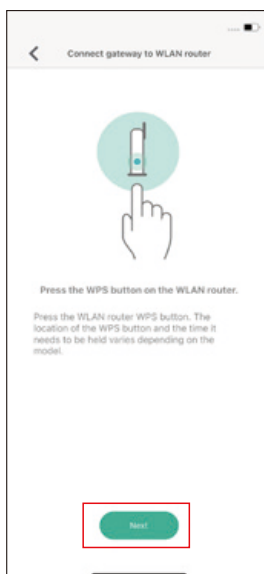

Press the WPS button on your WLAN Router.

Tap the "Next" button.

Note

The position and length of press required differs between WLAN Routers. Please check your WLAN Router specification.

If there is no WPS button



Enter the SSID and password for your WLAN Router.

Tap the "Connect" button.

8 Check the Status LED after 2 minutes. If lit, tap “LED is on” to complete WLAN setup.

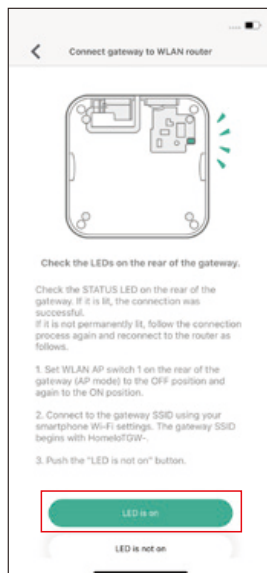

Check the Status LED on the rear of the Gateway after 2 minutes. If the Status LED is lit, the Gateway is successfully connected to the WLAN Router. Tap the “LED is on” button to complete WLAN setup.

Note

If the LED is not lit, tap the “LED is not on” button and try to connect the Gateway to the WLAN Router again by following the procedure below.

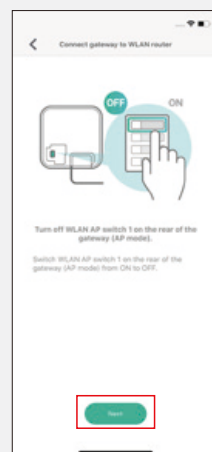

1. Turn the WLAN AP switch on the rear of the Gateway (switch 1) to the off position, then back to the on position.

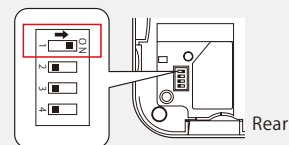

2. Check that the Gateway's Application LED flashes in orange.
3. Check that your smartphone is connected to the Gateway (connect to the Gateway SSID from your smartphone's network settings).
4. Follow the on-screen instructions to configure.

9 Re-connect your smartphone to the WLAN Router.



Select the SSID of the WLAN Router from your smartphone's Wi-Fi settings. Then, set the Gateway's WLAN AP switch (switch 1) to OFF.

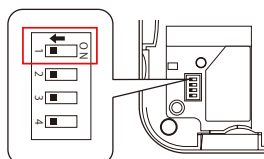

10 Re-open the App.



Once Wi-Fi settings have been changed, open the App again.

Error Messages

List of Error Codes

If an error message is shown in the Panasonic HOME IoT App, look it up in the error code list below.

Error Code		Name	Details
Type	Number		
U	01	Connection error	* Connection problem between the App and server
	02	Authentication error	* Authentication error on login
	03	Smartphone App startup error	* Smartphone App could not startup
	04	Browser startup error	* Smartphone App could not open an Internet browser
	10	Wireless device registration error	* Wireless device registration error (Power Measuring Unit , Temperature / Humidity Sensor)
	11	Gateway not found	* Gateway not responding to UpnP M-Search
	12	Gateway identification failure	* Could not acquire Gateway device ID
	13	Gateway could not connect to server	* Failed to connect to server
	14	Gateway failed to enter registration mode	* Gateway failed to enter registration mode
	30	Estimate error	* Another person is running an estimate
	31	Estimate error	* Estimate process error
	32	Scene settings error	* Scene settings number overflow
	33	Scene control error	* A device controlled by a scene has been removed
	34	Device data error	* A device has been removed
	35	Camera startup error	* Smartphone camera startup error

Useful materials for various devices can be found on the Home IoT homepage.

■ Home IoT Homepage

<https://industry.panasonic.eu/energy-building/home-iot>

System Overview



This system layout is representative of a system configuration as of July 2020.